

Sand Pup Trailer & Skid Units

SK300 & TR300

OWNERS MANUAL



SealMaster[®]

Pavement Products & Equipment

PO Box 2277 • Sandusky, Ohio 44870 • 419-626-4375

sealmaster.net

SANDPUP TRAILER & SKID UNITS

Owner's Manual

Version 2.8

Issue Date: April 2024

Effective Date: May 2019

Version	Date	Changes	Approval
1.0		Original Issue	
2.0	7/19	New Format and Updates	DS
2.1	1/22	Change Engine Oil – Note	JG
2.2	4/22	Added Paint Page	JG
2.3	5/22	Changed A3 To P458C048	JG
2.4	5/22	Breakaway Kit Change	JG
2.5	10/22	Added Site Gauge & Ramp	JG
	10/22	Changed H3 To P474A088	JG
2.6	8/23	Added Rolair Page	JG
2.7	9/23	Pump & Compressor Page	JG
2.8	4/24	Updated 1" ARO Pump List	JG

Table of Contents

CORRESPONDENCE	2
SealMaster® LIMITED WARRANTY	3
SAFETY PRECAUTIONS AND CAUTIONS	4
PRECAUTIONS.....	4
CAUTIONS.....	4
OPERATING INSTRUCTIONS	5
STARTUP – HYDRAULIC AGITATION	5
1-BEFORE STARTING THE ENGINE	5
STARTUP - COMPRESSOR.....	6
1-BEFORE STARTING THE ENGINE	6
2-STARTING THE ENGINE	7
3-START TO PUMP MATERIAL	9
4-START THE SPRAY WAND	10
5-WATER FLUSH	12
MAINTENANCE SCHEDULE	13
MAINTENANCE SCHEDULE	13
TROUBLE SHOOTING GUIDE.....	15
WIRING DIAGRAMS	17
ELECTRIC BRAKES AND RUNNING LIGHTS	17
TANK CAPACITY CHART.....	18
MATERIAL DEPTH AND GALLON VOLUME	18
MACHINE PICTURES AND PARTS LIST	19
PARTS LIST PICTURE-1	20
PARTS LIST PICTURE-2	21
PARTS LIST PICTURE-3	22
PARTS LIST PICTURE-4	24
PARTS LIST PICTURE-5	25
PARTS LIST PICTURE-6	26
PARTS LIST: MATERIAL PUMP & COMPRESSOR/HYD. PUMP ASSEMBLY	27
PARTS LIST FOR ARO 1” PUMP	28
PARTS LIST FOR ARO 1” PUMP	29
PARTS LIST FOR ROLAIR AIR COMPRESSOR / ENGINE	31
MAINTENANCE AND STORAGE	32

ThorWorks Industries, Inc.

Purchased by _____ Model NO. _____
Company Name _____ Serial NO. _____
Address _____ Acceptance Date _____
City _____ State _____ Zip _____

CORRESPONDENCE

All Correspondence regarding this equipment, as well as general correspondence should be addressed to:

ThorWorks Industries, Inc.

PO Box 2277

Sandusky, OH 44870

In referring to the equipment, kindly state the Model Number, Serial Number and any part number involved



SealMaster® LIMITED WARRANTY

SealMaster warrants that its products are of quality material and workmanship. SealMaster agrees to replace, within a period of one (1) year from date of delivery, or at its option, repair, without charge, any part of their manufacture which proved defective. The repair or replacement will be free of charge F.O.B. Sandusky, Ohio, providing the damaged part or parts are returned, freight prepaid, to SealMaster and investigation shows such repair or replacement is made necessary by an inherent defect of material or workmanship.

It is hereby understood that engines, motors, pumps, or other components purchased by SealMaster for use on its equipment are not warranted by SealMaster and are sold only with the standard warranty of the manufacturer of that component.

SealMaster will make no allowances for repairs or alterations completed by outside sources unless authorization is in writing and approved by an authorized SealMaster representative.

Any claims for defective material or workmanship must be made prior to the expiration of thirty (30) days from the date failure occurs, and in all cases prior to the expiration of the warranty period of one (1) year. It is the intent of this paragraph to limit SealMaster's liability solely to the cost of replacement parts, F.O.B. factory, or at the option of SealMaster to repair of the defective part or parts. No allowances for damages, lost time, or any other claim will be recognized.

This warranty is null and void if other than genuine SealMaster parts are used.

SealMaster is constantly striving to improve their products. Changes in design and improvement will be made whenever the manufacturer believes the efficiency of the product will be improved, without incurring any obligation to incorporate such improvements in any machines which have been shipped or are in service.

In an effort to continue to improve product quality, SealMaster reserves the right to change specifications without notice.

Any modification or alteration of this machine without prior approval of the manufacturer may void this warranty.

SAFETY PRECAUTIONS AND CAUTIONS

PRECAUTIONS

- **Always** wear **eye** and **ear** protection, and **gloves**.



- Be aware of all **CAUTION, WARNING, DANGER** signs on the unit.
- Read all Owners Manuals that come with this unit.
- Daily check the Engine, Air Compressor oil levels.
- Refer to Owners Manuals for proper types of oils.
- Make sure the operator is familiar with the units' operation.
- Shut down compressor engine prior to refilling the gas tank.
- Replace any hoses that show signs of wear, fraying or splitting.
- Be sure all fittings and joints are tight and leak proof.
- Do not do maintenance work on the unit while in operation.
- The unit should not be left unattended when running.

CAUTIONS

- Keep hands, feet, and clothing away from moving parts.
- Do not operate the machine without all guards in place.
- Do not point the spray applicators at another person.
- Do not operate the machine in an enclosed building or confined area.

SANDPUP TRAILER & SKID UNIT

APPLIES TO: SANDPUP TR 300

OPERATING INSTRUCTIONS

STARTUP – HYDRAULIC AGITATION

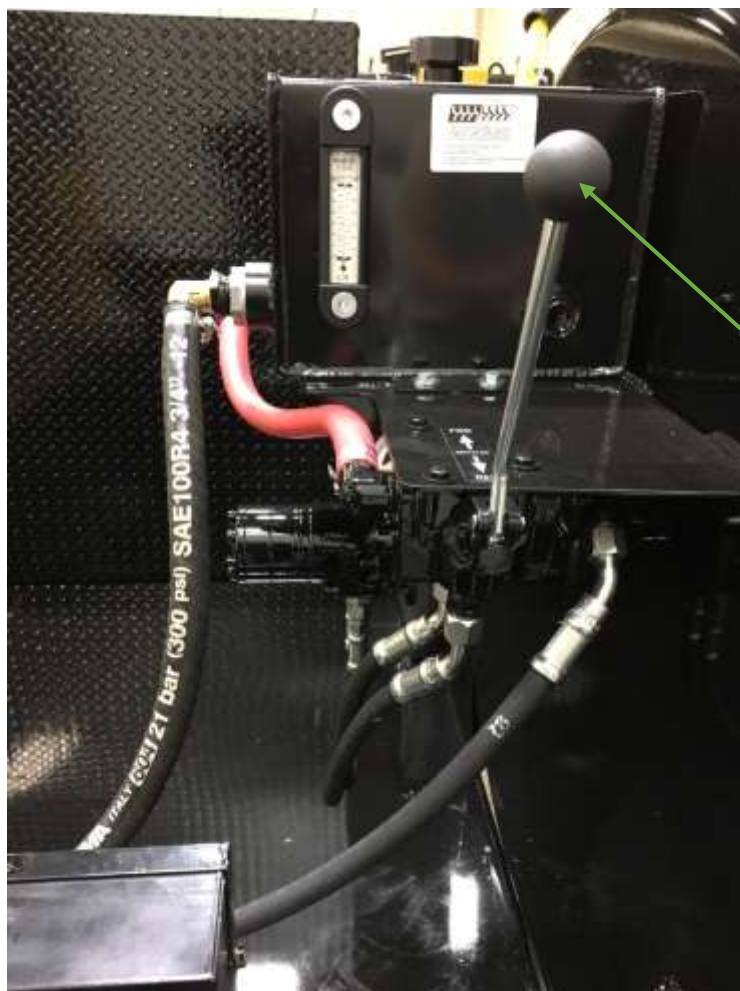

H2 AGITATOR
CONTROL

1-BEFORE STARTING THE ENGINE

- Make sure the agitator control valve **H2** is in the neutral position.

SANDPUP TRAILER & SKID UNIT

APPLIES TO: SANDPUP TR 300 AND SK 300

OPERATING INSTRUCTIONS

UP

STARTUP - COMPRESSOR

DOWN



1-BEFORE STARTING THE ENGINE

- Move the Pilot Unloader valve knob to the **Up** position before starting the engine.
- After the engine has warmed up, swing the lever back **Down**.

SANDPUP TRAILER & SKID UNIT

APPLIES TO: SANDPUP TR 300 AND SK 300

OPERATING INSTRUCTIONS

STARTUP – COMPRESSOR ENGINE



2-STARTING THE ENGINE

- Set the **fuel** shutoff and **choke** levers to the **on** position.
- Set the engine **on/off** switch to **on** position.
- Pull start the **engine**.
- The engine will run full throttle until the two air tanks are charged. The compressor gauge will show tank pressure of 125psi.
- Once the engine drops back to idle, the unit is ready to start pumping material.

SANDPUP TRAILER & SKID UNIT

APPLIES TO: SANDPUP SK 300

OPERATING INSTRUCTIONS

WITH **OPTIONAL** HYDRAULIC AGITATION

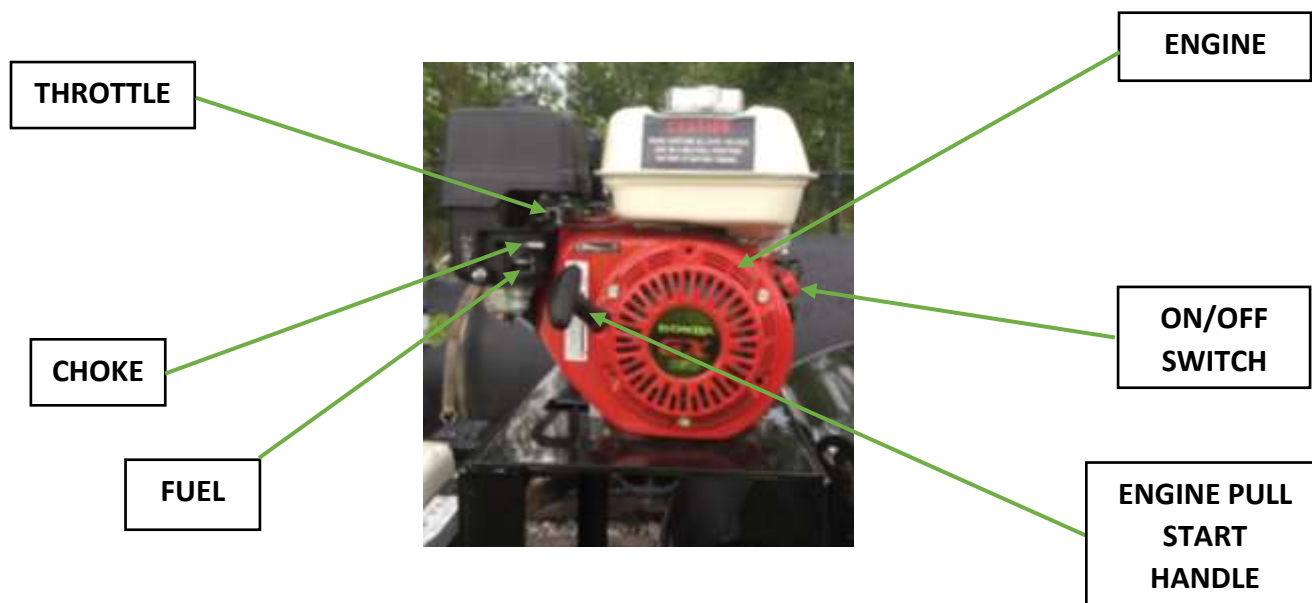

2-STARTING THE ENGINE

- Be sure the hydraulic valve is in the neutral position.
- Set the **fuel** shutoff and **choke** levers to the **on** position.
- Set the throttle lever at ½ open.
- Set the engine **on/off** switch to **on** position.
- Pull start the **engine**.



- It is important that when you are done running the engine that the **fuel** shutoff lever is turned to the **off** position. This keeps gasoline from mixing with oil as you are driving.

Refer to the engine manual.

SANDPUP TRAILER & SKID UNIT

APPLIES TO: SANDPUP TR 300 AND SK 300

OPERATING INSTRUCTIONS

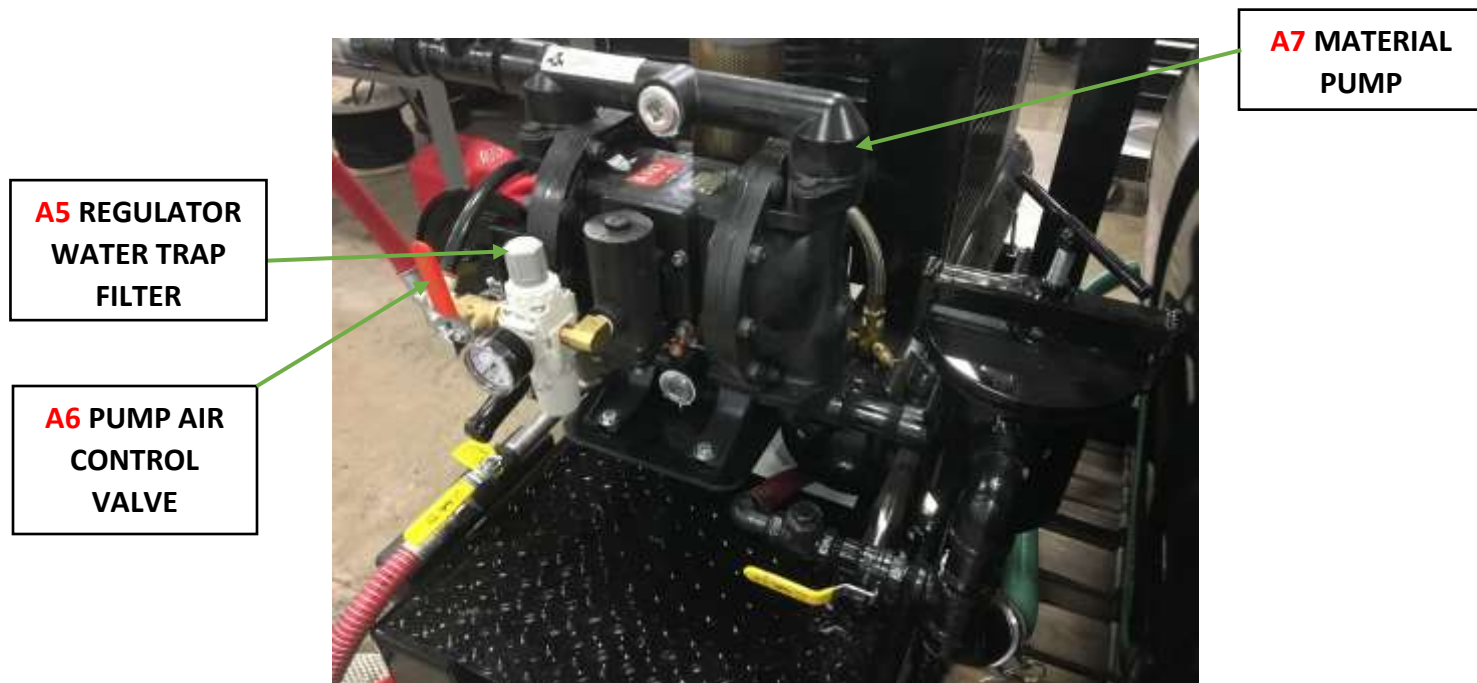

3-START TO PUMP MATERIAL

1. Attached to the regulator/water trap filter A5 is the pump air control valve A6, it regulates the volume of air that goes to the material pump A7 and the volume / GPM of material flow. The regulator's factory setting is 80 psi. It controls the spray pressure of the material pump A7.
2. It is only necessary to open the pump air control valve A6 part way – 1/4 to 1/2 is adequate.
3. **NOTE:** Opening all the way, will cause the material pump A7 to consume more air than the compressor can produce, which will cause the air pressure to drop.

SANDPUP TRAILER & SKID UNIT

APPLIES TO: SANDPUP TR 300 AND SK 300

OPERATING INSTRUCTIONS

M1 MATERIAL
HOSE FEED



P30 SPRAY TIP
80/70

A5 REGULATOR
WATER TRAP
FILTER



M6 SPRAY
WAND VALVE

4-START THE SPRAY WAND

1. Open material hose feed valve M1 to pressurize the hose, then the spray wand valve M6. To start spraying. Hold the wand at waist level and walk at a steady pass lapping each pass 50%.
2. The thickness of the material determines how much pressure is needed to properly atomize the material, only use enough pressure to atomize the material. This will reduce overspray.
3. Adjust the pressure setting on regulator/water trap A5 to get a proper spray pattern. To do this, turn the knob on top of the regulator in for more or out for less pressure. When the material is coming out of the spray tip 80/70 P30, you will feel the wand push up.

SANDPUP TRAILER & SKID UNIT

APPLIES TO: SANDPUP TR 300 AND SK 300

OPERATING INSTRUCTIONS

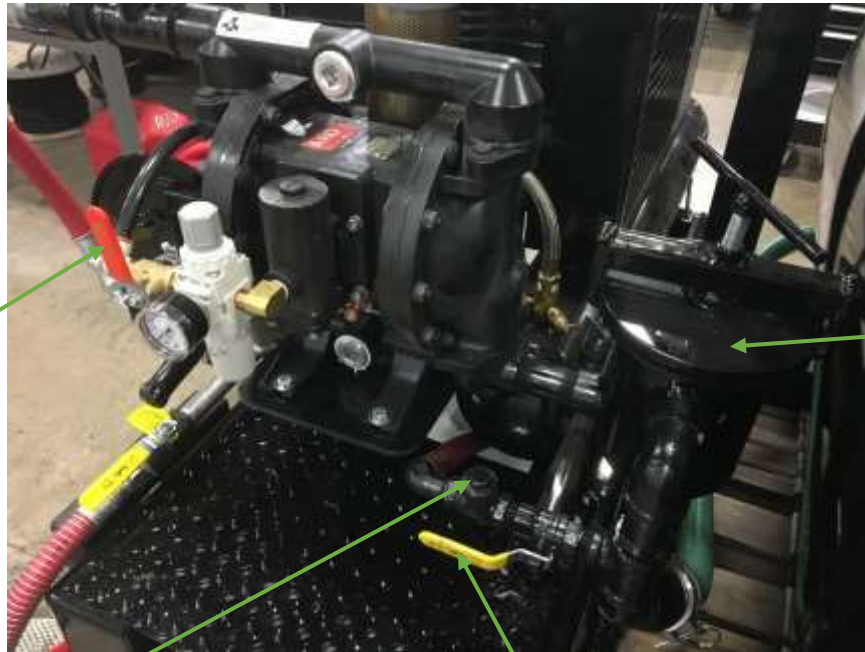

A6 PUMP AIR CONTROL VALVE

M2 BASKET STRAINER

P10 WATER CHECK VALVE

M3 WATER FLUSH VALVE



M6 SPRAY WAND VALVE

M5 MAIN TANK VALVE



SANDPUP TRAILER & SKID UNIT

APPLIES TO: SANDPUP TR 300 AND SK 300

OPERATING INSTRUCTIONS

5-WATER FLUSH

1. It is not necessary to flush the system every day. We suggest removing the spray tip and plugging the wand, when not in use or transporting from job to job.
2. If the machine is going to be out of service for a week or more, then water flush the system.
3. If outfitted with the water option, close main tank valve M5 and open the small water flush valve M3 that is on the basket strainer M2.
4. Open pump air control valve A6 and your spray wand valve M6. Pump until water runs clear.
5. On basket strainer M2 is a water check valve P10, this helps keep sealer from flowing into the water tank if you leave the valve open. Do not rely on this check valve, always close the water flush valve M3.
6. If you do not have the water option, close main tank valve M5. Remove the lid assembly from the basket strainer M2.
7. Open pump air control valve A6 and pour water into the basket strainer M2, as it is being pumped to the spray wand.

Note: Skid tank configuration is different from the trailer, but the operation is the same.

SANDPUP TRAILER & SKID UNIT

APPLIES TO: SANDPUP TR 300 AND SK 300

MAINTENANCE SCHEDULE

MAINTENANCE SCHEDULE

Follow maintenance procedures listed in the engine and compressor manuals.

MAINTAIN	8 HRS	1 WEEK	1 MONTH	6 MONTHS	1 YEAR
CHECK ENGINE OIL LEVEL	✓				
CHANGE ENGINE OIL *					
CHECK COMPRESSOR OIL LEVELS	✓				
CHANGE COMPRESSOR OIL			✓		
INSPECT COMPRESSOR AIR FILTER	✓				
CHANGE COMPRESSOR AIR FILTER			✓		
DRAIN WATER FROM COMPRESSOR		✓			
DRAIN WATER FROM REGULATOR	✓				
TIGHTEN V-BELT		✓			
REPLACE V-BELT					✓
CHECK BREAKAWAY BOX BATTERY	✓				
CHECK TIRE PRESSURE			✓		

*CHANGE ENGINE OIL - OIL SPECIFICATIONS / REFER TO ENGINE MANUAL

Honda Recommends **20hrs Initial Start** / every 100hrs or 6 mons. After

SANDPUP TRAILER & SKID UNIT

APPLIES TO: SANDPUP TR 300 AND SK 300

MAINTENANCE SCHEDULE

ON THE **OPTIONAL** HYDRAULIC AGITATION ASSEMBLY

Follow maintenance procedures listed on the **engine** manual.

MAINTAIN	8 HRS	1 WEEK	1 MONTH	6 MONTHS	1 YEAR	2 YEARS
CHECK HYDRAULIC OIL LEVELS	✓					
CHANGE HYDRAULIC OIL *						✓
CHANGE HYDRAULIC OIL FILTER					✓	
CLEAN HYDRAULIC SUCTION STRAINER					✓	
CHECK CHAIN & SPROCKET / DRIVE		✓				
CHECK AGITATOR DRIVE SYSTEM - TIGHTEN CHAINS & SET SCREWS		✓				
INSPECT ALL HOSES	✓					

* Use a good quality AW68 hydraulic oil with a rating of 352 SUS @100 F. Do not use a 150 rated hydraulic oil as it is too light.

SANDPUP TRAILER & SKID UNIT

APPLIES TO: SANDPUP TR 300 AND SK 300

TROUBLE SHOOTING GUIDE

PROBLEM	POSSIBLE CAUSES/SOLUTIONS
AIR COMPRESSOR NOT PRODUCING ENOUGH AIR OR PRESSURE	BELTS LOOSE / TIGHTEN THE BELTS
	PILOT UNLOADER VALVE / REFER TO OWNER'S MANUAL
ENGINE ISSUES	OIL SPECIFICATIONS / REFER TO OWNER'S MANUAL
	OPERATING INSTRUCTIONS / REFER TO OWNER'S MANUAL
	FUEL IN OIL CRANKCASE / FUEL SHUT-OFF VALVE IN OFF POSITION WHEN FINISHED
MATERIAL PUMP MATERIAL FLOW IS REDUCED	BASKET STRAINER IS PLUGGED / UNPLUG AND CLEAN
	PLUMBING LEADING TO PUMP IS PLUGGED / UNPLUG AND CLEAN
	PUMP WORN / NEEDS NEW BALLS AND BALL SEATS REPLACED
	MATERIAL TOO THICK/ THIN WITH WATER
MATERIAL PUMP WILL NOT CYCLE	AIR VALVE IS STUCK / CLEAN AND LUBRICATE NO AIR TO PUMP / CHECK COMPRESSOR, VALVES, AND REGULATOR
MATERIAL PUMP AIR COMING OUT OF SPRAY TIP	DIAPHRAGM HAS A TEAR / REPLACE ONE OR BOTH
	LOOSE SUCTION LINE / SEAL AND TIGHTEN
	BASKET STRAINER LID NOT SEALING / SEAT PROPERLY OR REPLACE
MATERIAL PUMP SEALER COMING OUT	DIAPHRAGM IS LOOSE / REPLACE ONE OR BOTH
MATERIAL PUMP AIR COMING OUT OF PUMP	AIR VALVE FAULTY/ REPLACE VALVE
MATERIAL PUMP DOES NOT STALL WHEN SPRAY WAND IS CLOSED	BASKET STRAINER IS PLUGGED / UNPLUG
	PLUMBING LEADING TO PUMP IS PLUGGED / UNPLUG
	PUMP NEEDS REBUILT / REBUILT PUMP

SANDPUP TRAILER & SKID UNIT

APPLIES TO: SANDPUP TR 300 AND SK 300

TROUBLESHOOTING GUIDE

PROBLEM	POSSIBLE CAUSES/SOLUTIONS
SURGE TANK EXCESSIVE PULSATION	SURGE TANK PLUGGED / CLEAN OUT TANK
	DIAPHRAGM PUMP BALL OR SEAT / REPLACE AS NEEDED
AIR REGULATOR DROPS PRESSURE	CHECK VALVE IS DAMAGED / INSPECT BALLS AND BALL SEATS
BASKET STRAINER EXCESSIVE PLUGGING	MATERIAL CHUNKS / EMPTY TANK-FLUSH WITH WATER AND CLEAN TANK
	EXCESSIVE SAND / LACK OF SEALER VISCOSITY MODIFIER
CHAINS NOT CONTACTING SPROCKETS PROPERLY	CHAIN TENSION IMPROPERLY ADJUSTED / ADJUST CHAIN TIGHTENER
	SPROCKET TEETH WORN / REPLACE SPROCKET
OPTIONAL HYDRAULIC AGITATION DOES NOT ROTATE	SHUTOFF VALVE IS CLOSED / OPEN VALVE
	HYDRAULIC OIL LOW / FILL OIL LEVEL 4" FROM TOP OF TANK
	HYDRAULIC AGITATOR MOTOR NOT WORKING / REPLACE AGITATOR MOTOR
	COUPLER KEY / REPLACE THE SHEARED KEY
	CHAIN BROKEN / REPLACE THE CHAIN
	HYDRAULIC PUMP NOT WORKING / HAVE TESTED OR REPLACED

SURGE TANK – NOTE: WEARING OF A FACE SHIELD IS RECOMMENDED

PRESSURE CAN BE RELIEVED FROM SYSTEM BY OPENING THE SPRAY WAND AND MATERIAL HOSE FEED VALVES AND IF NECESSARY, REMOVING THE SPRAY TIP.

KEEP IN MIND THE PLUMBING CONNECTING THE PUMP TO THE SURGE TANK COULD ALSO BE PLUGGED, AND THERE MAY BE RESIDUAL PRESSURE STILL IN THE SYSTEM.

WIRING DIAGRAMS

ELECTRIC BRAKES AND RUNNING LIGHTS

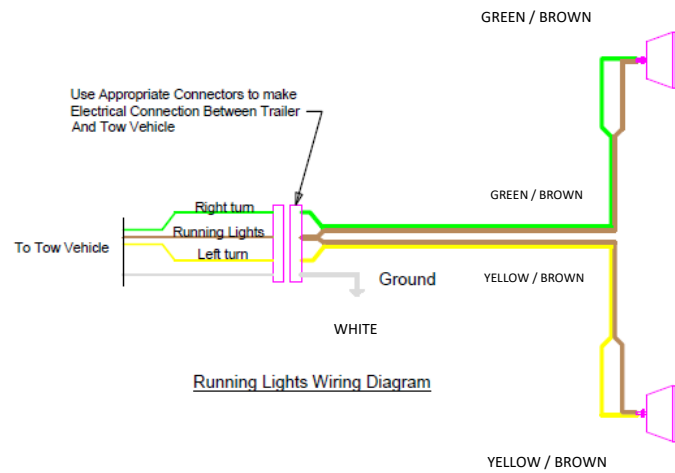
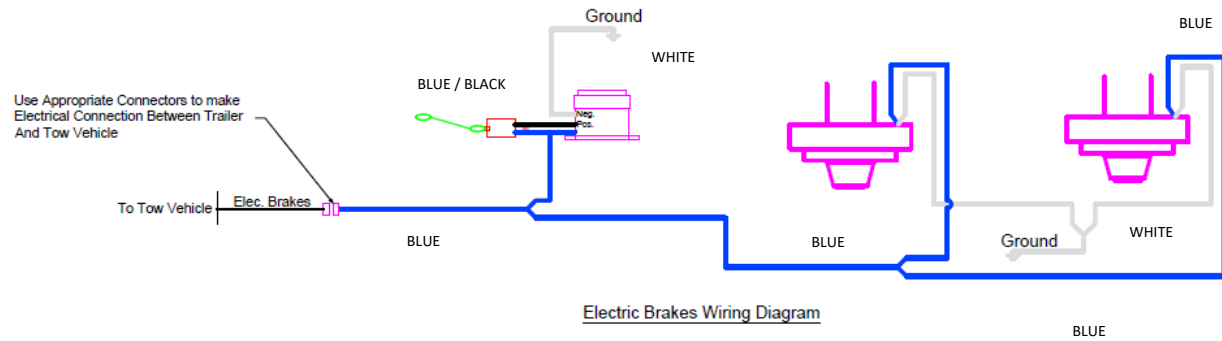

TANK CAPACITY CHART					
GALLONS ARE APPROXIMATE AND MAY VARY SLIGHTLY TANK TO TANK					
MATERIAL DEPTH AND GALLON VOLUME					
MATERIAL DEPTH	300 GALLONS 41"x54"			MATERIAL DEPTH	300 GALLONS 41"x54"
INCHES	GALLONS			INCHES	GALLONS
1	2			25	197
2	6			26	206
3	10			27	216
4	15			28	225
5	21			29	233
6	28			30	242
7	35			31	250
8	42			32	258
9	50			33	266
10	58			34	274
11	67			35	281
12	75			36	287
13	84			37	293
14	93			38	298
15	102			39	303
16	112			40	307
17	121			41	309
18	130			42	
19	140			43	
20	150			44	
21	159			45	
22	169			46	
23	178			47	
24	188			48	

SANDPUP TRAILER & SKID UNIT

APPLIES TO: SANDPUP TR 300 AND SK 300

MACHINE PICTURES AND PARTS LIST

PICTURE-1

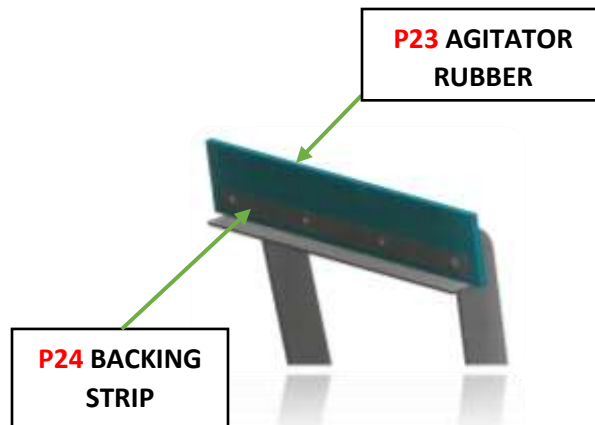
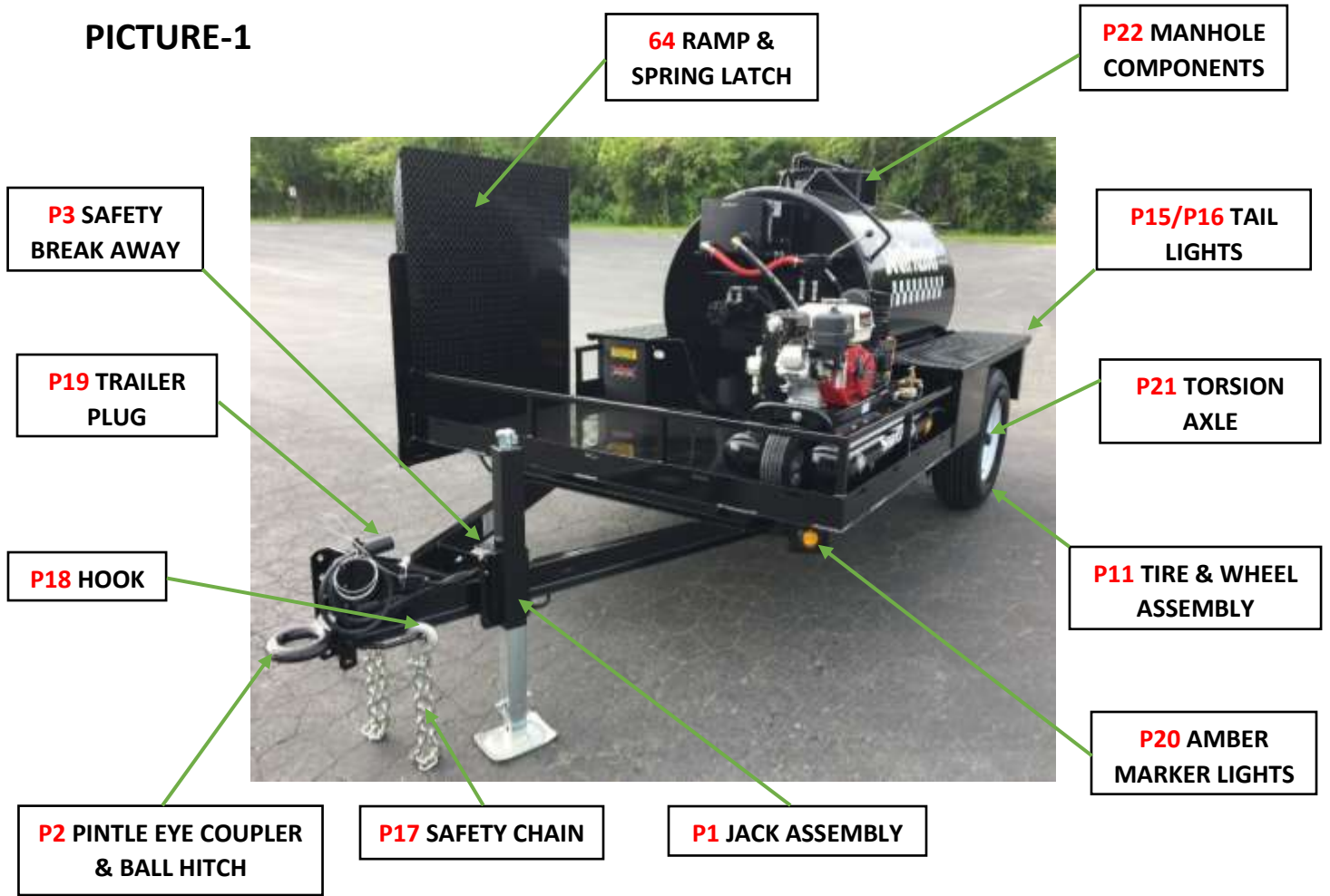

SANDPUP TRAILER & SKID UNIT

APPLIES TO: SANDPUP TR 300 AND SK 300

PARTS LIST PICTURE-1

ITEM #	PART#	QTY.	DESCRIPTION
			MANHOLE COMPONENTS
P22	P639B004	1	RETAINING RING WITH SPLASH GUARD
	P639B005	1	LID MANHOLE WITH VENT – DRIP EDGE
	P639A009	1	GASKET-MANHOLE LOW TEMPERATURE
	P639A006	1	LATCH & HARDWARE
P23	P459A017	2	AGITATOR RUBBER
P24	P72000B012	2	BACKING STRIP

PARTS LIST – TRAILERS ONLY

ITEM #	PART#	QTY.	DESCRIPTION
P1	P551A008	1	JACK ASSEMBLY
P2	P553A008	*	2-5/16" BALL HITCH
P2	P646A003	*	PINTLE EYE COUPLER
P3	P518A008	1	BREAKAWAY KIT – 4BOLT
	P518A004	1	BREAKAWAY KIT BEFORE 10/2019
P11	P514A017	2	TIRE & WHEEL ASSEMBLY
P15	P516A025	1	LEFT SIDE TAIL LIGHT
P16	P516A024	1	RIGHT SIDE TAIL LIGHT
P17	P531A004	2	SAFETY CHAIN
P18	P517A002	2	HOOK (PART OF SAFETY CHAIN)
P19	P51PA007	1	TRAILER PLUG
P20	P467A016	2	AMBER MARKER LIGHT
P21	P511A013	1	TORSION AXLE
P32	P72000D073	1	RAMP
	P953A008	1	SPRING LATCH

* DENOTES YOUR CHOICE

SANDPUP TRAILER & SKID UNIT

APPLIES TO: SANDPUP TR 300 AND SK 300

PICTURE-2



**P6 BEARING
SEAL**

**P5 FLANGE
BEARING**

**P25 BEARING
PLATE**

**P9 WATER
TANK**

PARTS LIST

PARTS LIST PICTURE-2

ITEM #	PART#	QTY.	DESCRIPTION
P6	P50137B009	2	BEARING SEAL
P5	P432A003	2	FLANGE BEARING 1-1/4" BORE
P25	P50137B008	2	BEARING PLATE
P9	P596A001	1	WATER TANK – OPTIONAL ON TR 300

SANDPUP TRAILER & SKID UNIT

APPLIES TO: SANDPUP SK 300

PARTS LIST

WITH GEAR REDUCTION

PARTS LIST PICTURE-3

ITEM #	PART#	QTY.	DESCRIPTION
P4	P426A014	1	SPROCKET 1-1/4" BORE WITH 3/8" KEY
P8	P462A002	2	FLANGE BEARING 1" BORE
P7	P426A001	1	SPROCKET 1" BORE
P26	P1038A000	1	#40 CHAIN ROLLER (SOLD PER FOOT)
	P1035A001	1	#40 MASTER LINK
P27	P50000A004	1	HAND CRANK ASSEMBLY (SPROCKET)

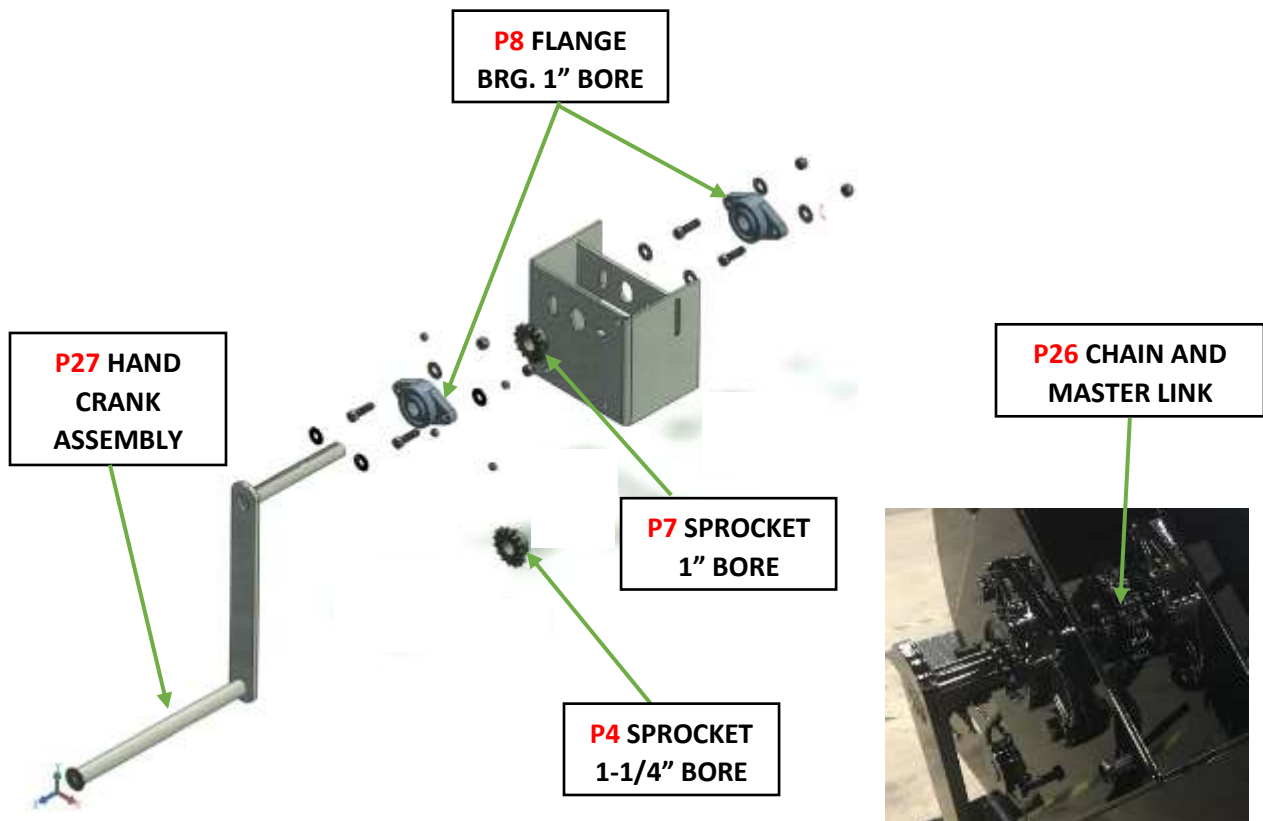

SANDPUP TRAILER & SKID UNIT

APPLIES TO: SANDPUP TR 300 AND SK 300

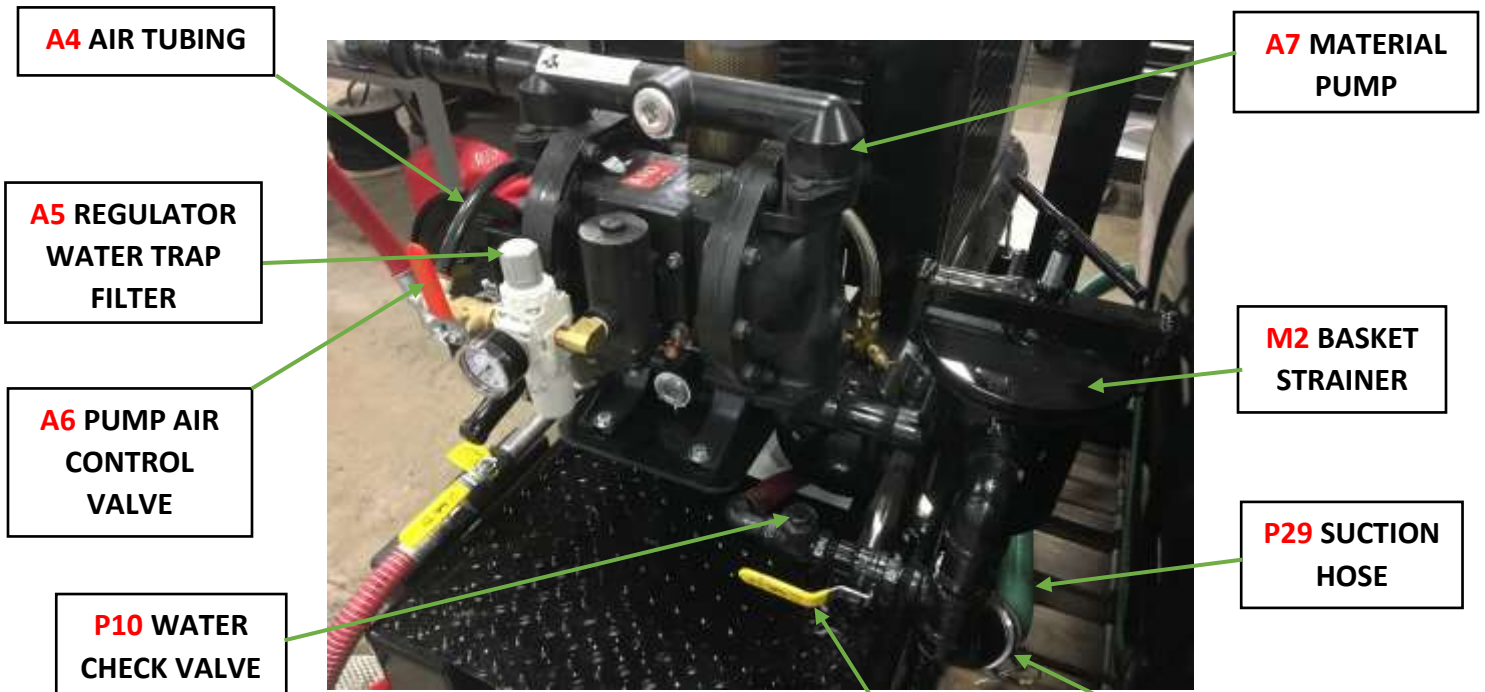

PICTURE-4

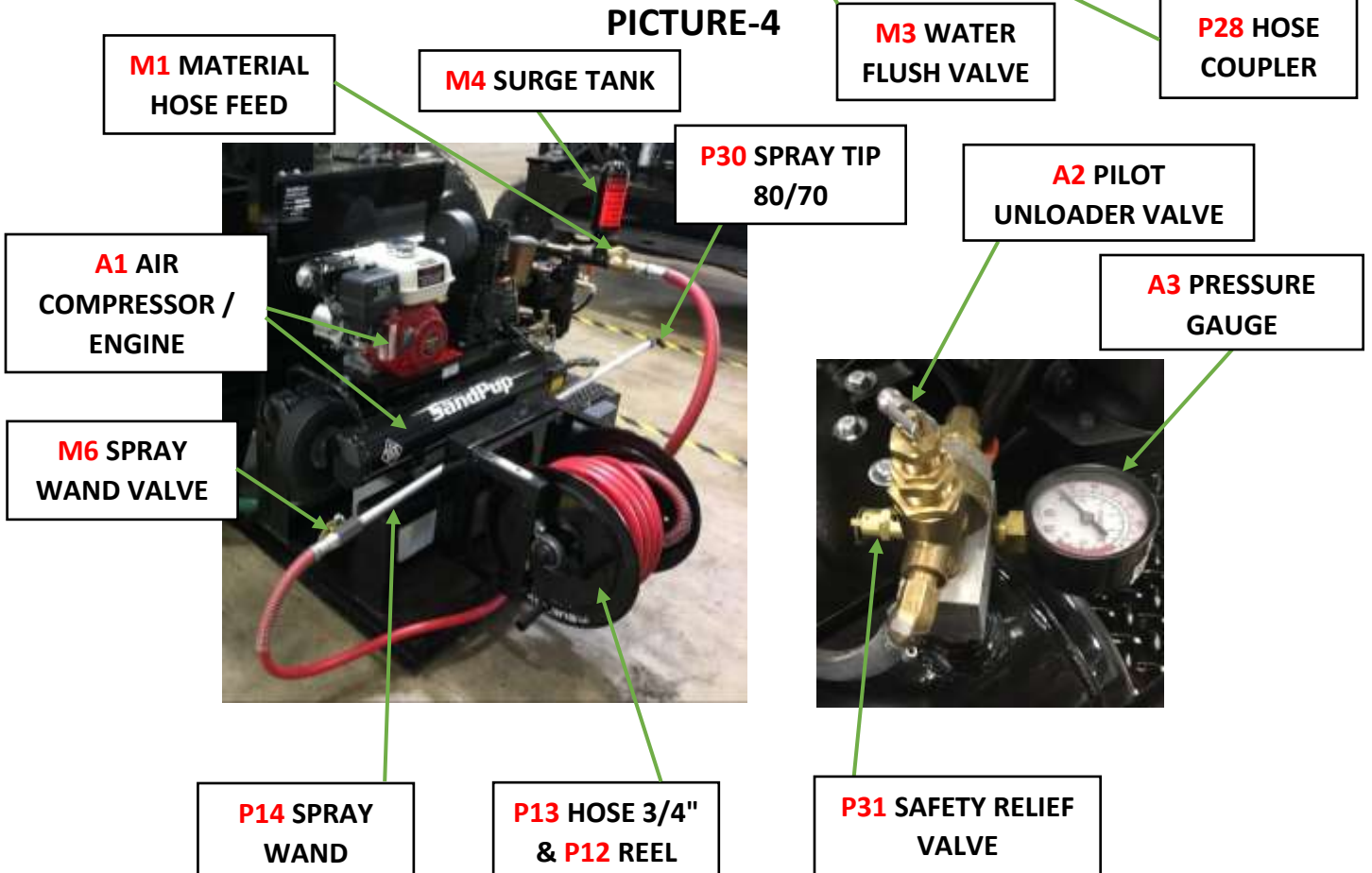

SANDPUP TRAILER & SKID UNIT

APPLIES TO: SANDPUP TR 300 AND SK 300

PARTS LIST

PARTS LIST PICTURE-4

ITEM #	PART#	QTY.	DESCRIPTION
A1	P458A045	1	AIR COMPRESSOR / ENGINE
	P458A022	1	ENGINE 5 HP ONLY
	P458C044	1	AIR COMPRESSOR FILTER
A2	P458C017	1	PILOT UNLOADER VALVE
A3	P458C048	1	PRESSURE GAUGE
A4	P709C018		POLY AIR TUBING "SOLD BY THE FOOT"
A5	P735A046	1	REGULATOR/WATER TRAP FILTER
A6	P397A033	1	PUMP AIR CONTROL VALVE-1/4" BALL BRASS
A7	P640A060	1	DIAPHRAGM PUMP-MATERIAL 1" ARO
M1	P397A001	1	SPRAY HOSE FEED VALVE 3/4" BALL
M2	P50147B004	1	BASKET STRAINER ASSEMBLY
M3	P397A009	1	WATER FLUSH VALVE 1/2" BALL
M4	P30003E	1	SURGE TANK
M5	P397A002	1	MAIN TANK VALVE 2"
M6	P397A010	1	SPRAY WAND VALVE 3/4" BALL STEEL
P10	P398A001	1	WATER CHECK VALVE – OPTIONAL ON TR 300
P12	P901A001	1	HOSE REEL
P13	P754B026	1	3/4" HOSE X 75' LONG
P14	P50273B	1	SPRAY WAND
P28	P477A018	1	1" HOSE COUPLER
P29	P715C000	1	SUCTION HOSE
P30	P449A004	1	SPRAY TIP 80/70 – 3/8 NPT STEEL
P31	P458C022	1	SAFETY RELIEF VALVE

SANDPUP TRAILER & SKID UNIT

APPLIES TO: SANDPUP TR 300

PARTS LIST WITH HYDRAULIC AGITATION

PARTS LIST PICTURE-5

ITEM #	PART#	QTY.	DESCRIPTION
H1	P601A041	1	HYDRAULIC PUMP
H2	P472A016	1	AGITATOR CONTROL VALVE
	P939A025	1	HYD. VALVE – SEAL KIT (Brand M)
H3	P474A088	1	HYDRAULIC AGITATOR MOTOR
H4	P599A003	1	HYDRAULIC OIL TANK
	P599C001	1	HYDRAULIC BREATHER CAP
	P599C002	1	SITE LEVEL GAUGE
H5	P498A004	1	COUPLING 1-1/4" BORE WITH 3/8" KEY COUPLING 1" BORE WITH 1/4" KEY
H6	P498A010	1	PUMP SHAFT COUPLING

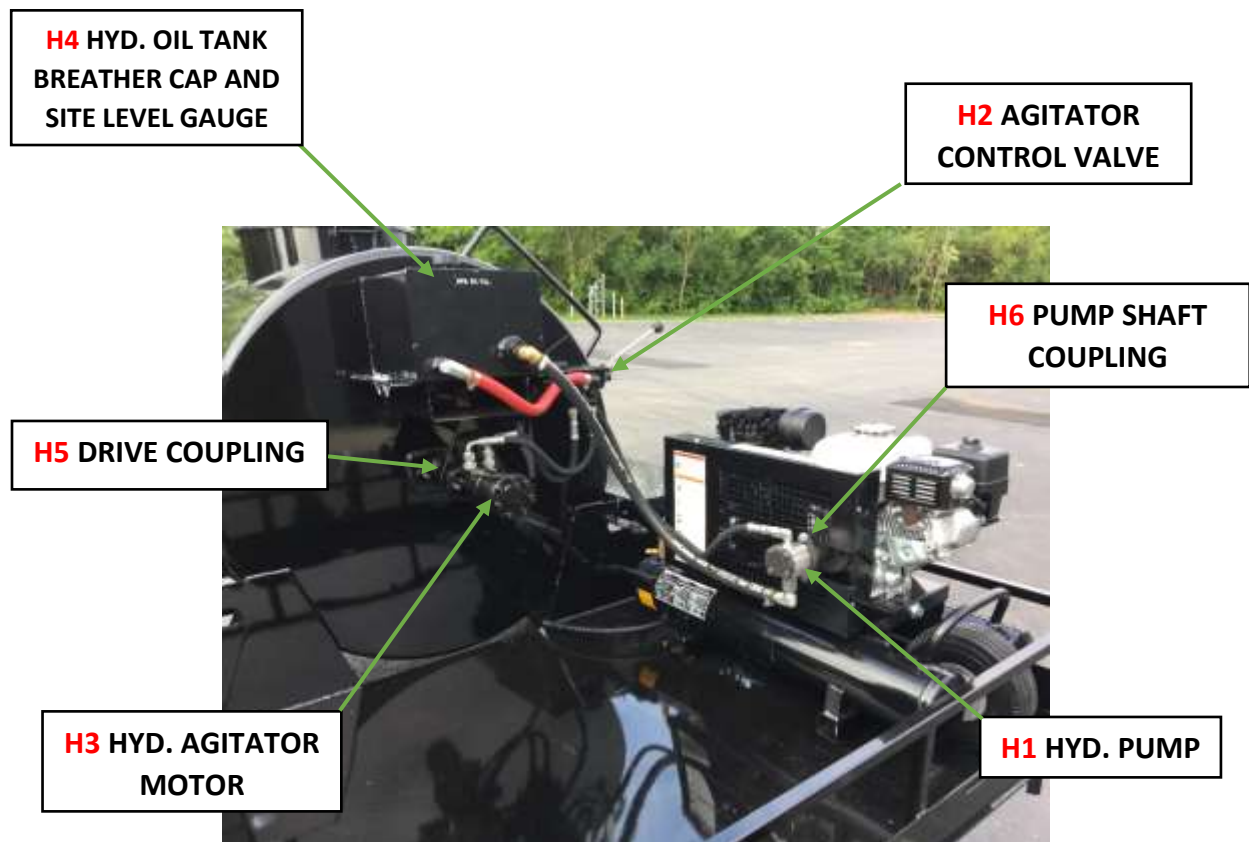

SANDPUP TRAILER & SKID UNIT

APPLIES TO: SANDPUP SK 300

PARTS LIST

WITH **OPTIONAL** HYDRAULIC AGITATION

PARTS LIST PICTURE-6

ITEM #	PART#	QTY.	DESCRIPTION
H1	P601A041	1	HYDRAULIC PUMP
H2	P472A016	1	AGITATOR CONTROL VALVE
	P939A025	1	HYD. VALVE – SEAL KIT (Brand M)
H4	P599A003	1	HYDRAULIC OIL TANK
	P599C001	1	HYDRAULIC BREATHER CAP
	P599C002	1	SITE LEVEL GAUGE
H7	P458A022	1	HONDA ENGINE GX160
H8	P630A035	1	JAW COUPLER 3/4" BORE WITH 3/16" KEY
	P630A045	1	JAW COUPLER 1/2" BORE WITH 1/8" KEY
	P631A005	1	COUPLER INSERT FOR JAW COUPLER
H9	P408A004	1	SUCTION STRAINER (HYD. TANK)
H10	P604A018	1	PUMP MOUNT BRACKET

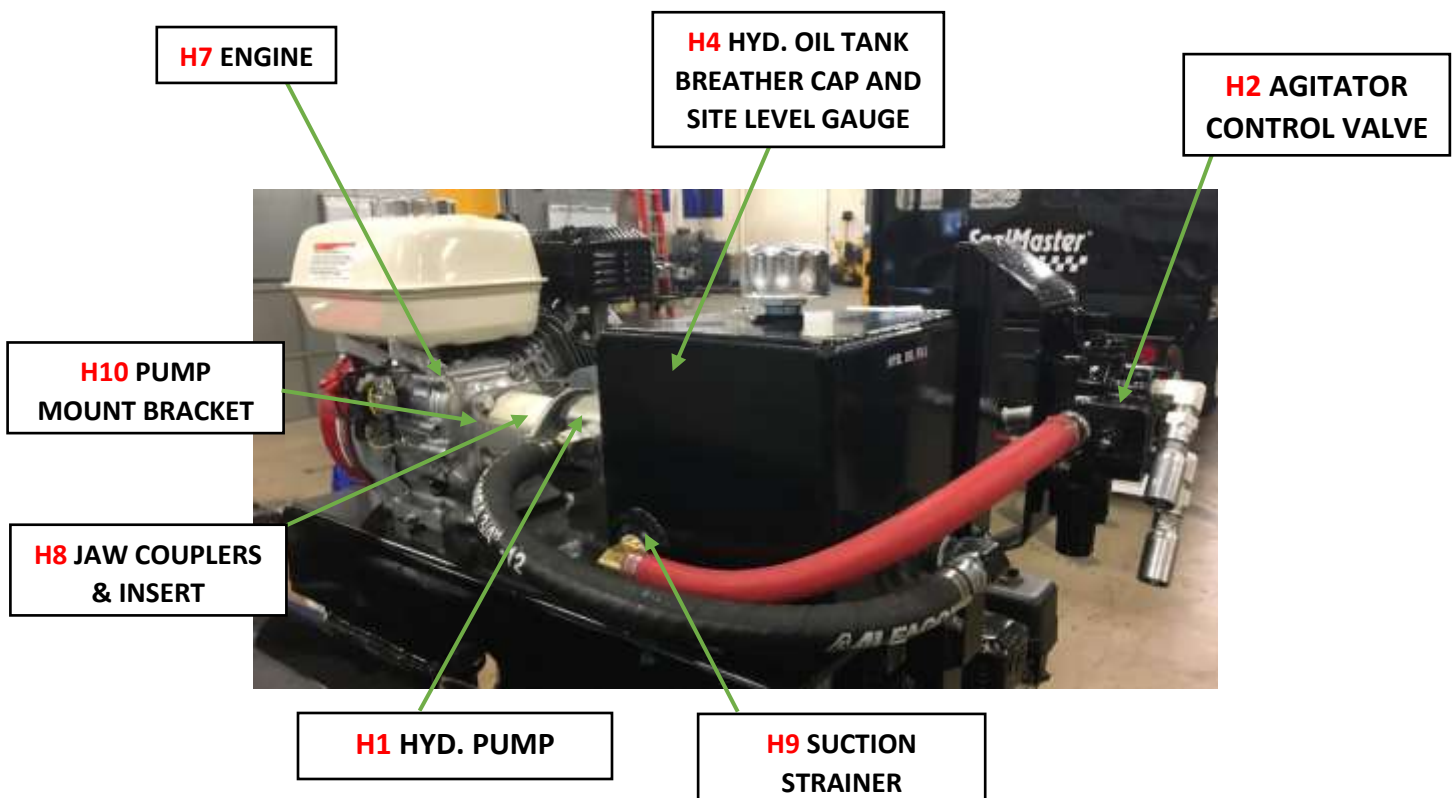

SANDPUP TRAILER & SKID UNIT

APPLIES TO: SANDPUP SK 300

PARTS LIST

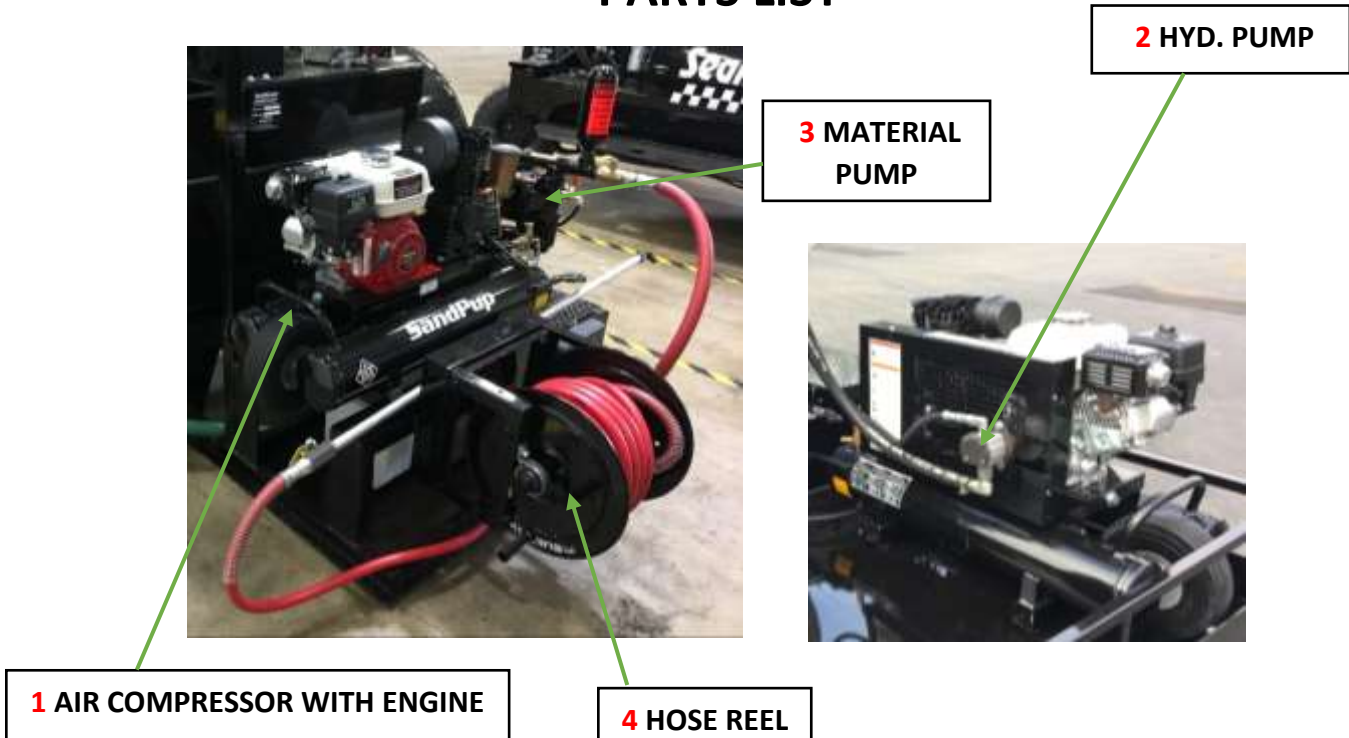

PARTS LIST: MATERIAL PUMP & COMPRESSOR/HYD. PUMP ASSEMBLY

ITEM #	PART#	QTY.	DESCRIPTION
	P72000N002	1	AIR COMPRESSOR & HYD. PUMP ASSEMBLY
1	P458A045	1	AIR COMPRESSOR WITH ENGINE
	P458A022	1	ENGINE 5 HP ONLY
2	P601A041	1	SMALL HYDRAULIC PUMP
	P72000V002	1	TR-SETUP 1" ARO PUMP ASSEMBLY
3	P640A060	1	1" ARO MATERIAL PUMP ONLY
	P72000V002	1	SK-SETUP 1" ARO PUMP ASSEMBLY
	P640A060	1	1" ARO MATERIAL PUMP ONLY
4	P901A001	1	HOSE REEL
	P754B026	1	3/4" HOSE X 75' LONG

SANDPUP TRAILER & SKID UNIT

APPLIES TO: SANDPUP TR 300 AND SK 300

PARTS LIST FOR ARO 1" PUMP

DESCRIPTION	S/M PART #	QTY.
ARO 1" PUMP	P640A060	1
AIR VALVE KIT	P975A060	1
GASKET	P975A019	2
O-RING 3/32" X 13/16" O.D.	P975A022	2
WASHER .406 I.D. X .031" THICK	P975A023	4
GASKET-TRACK	P976A031	1
GASKET	P975A037	1
U CUP 3/16" X 1-5/8" O.D.	P975A038	1
U CUP 3/16" X 1-1/8" O.D.	P975A039	1
GASKET-TRACK	P976A041	2
PILOT PISTON - WITH O-RING & U CUP	P975A043	1
O-RING 3/32" X 1-1/8" O.D.	P975A047	1
O-RING 1/16" X 1-1/8" O.D.	P975A048	1
O-RING 3/32" X 1-3/8" O.D.	P975A049	2
O-RING 1/8" X 1/2" O.D.	P975A050	2
DIAPHRAGM CHECK VALVE	P975A051	2
GASKET	P975A053	1
FML-2 GREASE	P975A056	1
MATERIAL PUMP REBUILD KIT	P975A059	1
DIAPHRAGM HYTREL	P975A004	2
SEAT- HYTREL	P975A008	4
BALL- HYTREL	P975A009	4
GASKET	P975A019	2
U CUP 3/16" X 1-1/8" O.D.	P975A021	2
FML-2 GREASE	P975A056	1

*** Note: Refer to the owner's manual or call customer service for additional parts.**

SANDPUP TRAILER & SKID UNIT

APPLIES TO: SANDPUP TR 300 AND SK 300

PARTS LIST FOR ARO 1" PUMP

DESCRIPTION	S/M PART #	QTY.
ARO 1" PUMP	P640A060	1
MAJOR VALVE KIT	P975A058	1
SCREW	P975A027	
SPOOL	P975A028	
PIPE PLUG	P975A031	
GASKET	P976A031	
VALVE BLOCK	P975A035	
END CAP	P975A036	
GASKET	P975A037	
U CUP	P975A038	
U CUP	P975A039	
VALVE INSERT	P975A040	
VALVE PLATE	P975A041	
GASKET	P976A041	
DIAPHRAGM – CHECK VALVE	P976A050	
GASKET	P976A052	
ADAPTER PLATE	P976A054	
MUFFLER	P976A053	1

*** Note: Refer to the owner's manual or call customer service for additional parts.**

ROLAIR
SCHEMATIC FOR
4090HK17

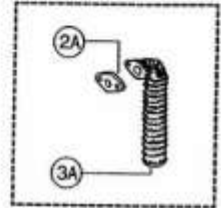
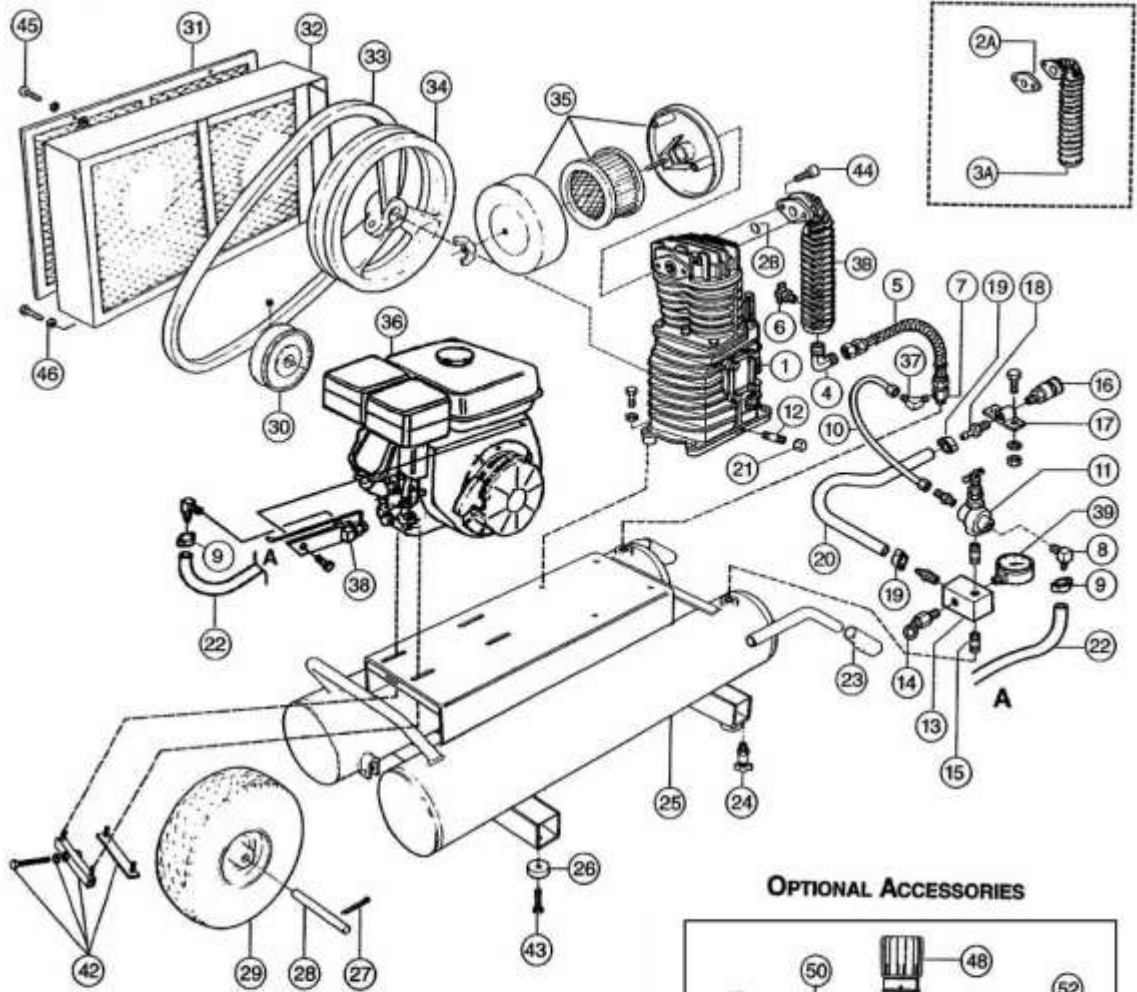
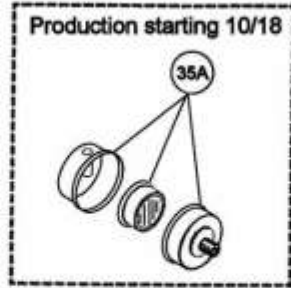

OPTIONAL ACCESSORIES

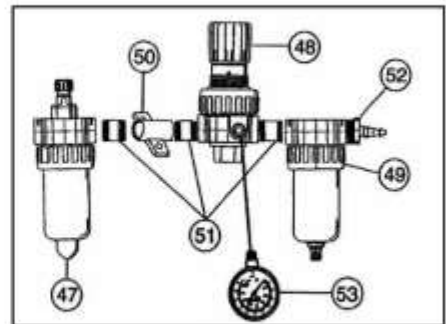

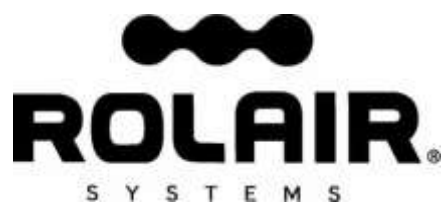

PARTS LIST FOR MODEL 4090HK17

PARTS LIST FOR ROLAIR AIR COMPRESSOR / ENGINE

Schem #	Description	Part #	Qty.	Schem #	Description	Part #	Qty.
1	Twin Cylinder Pump with Flywheel	P458C001	1	26	Rubber Foot	P458C034	4
	Twin Cylinder Pump less Flywheel	P458C002	1	27	Cotter Pin	P458C035	2
2A	Gasket	P458C003	1	28	Axle	P458C036	1
2B	O Ring	P458C004	1	29	Foam Filled Hat Free Tire	P458C037	1
3A	Aftercooler	P458C005	1	30	Pulley	P458C038	1
3B	Aftercooler O Ring Style	P458C006	1	31	Belt Guard Cover	P458C039	1
4	Brass Elbow	P458C007	1	32	Belt Guard (Base & Cover)	P458C040	1
5	Braided Discharge Tube	P458C008	1	33	Belt	P458C041	1
6	Drain Valve	P458B092	1	34	Flywheel	P458C042	1
7	Check Valve	P458C010	1	35	Intake Filter Assembly (before 10/18)		1
	Safety Valve (1/8")**		1		Filter Element for FS14050		1
8	Brass Elbow	P458C011	FOOT	35A	Intake Filter Assembly (after 10/18)	P458C043	1
9	Hose Clamp	P458C012	FOOT		Filter Element for FS10052	P458C044	1
10	1/4" Nylon Tube 14.4"	P458C013	1.2'	36	Honda Engine	P458A022	1
	Brass Nut	P458C014	FOOT	37	Brass Elbow	P458C046	1
	Brass Sleeve	P458C015	FOOT	38	Throttle Control Kit	P458C047	1
	Brass Ring	P458C016	FOOT	39	Pressure Gauge	P458C048	1
				40	Nipple	P458C049	1
				41			
11	Pilot Unloader Valve	P458C017	1	42	Belt Tightener/Mounting Kit	P458C051	1
	Felt Muffler	P458C018	1	43	Screw	P458C052	4
	Retainer Ring	P458C019	1	44	Bolt	P458C053	FOOT
12	Nipple	P458C020	1	45	Spin Lock Bolt		5
13	Aluminum Block Manifold	P458C021	1		Self tapping Screw		5
14	Safety Relief Valve	P458C022	1	46	Bolt		FOOT
15	Nipple	P458C023	1		Lock Washer		FOOT
16	Quick Disconnect	P458C024	1		Washer		FOOT
17	Accessory Bracket	P458C025	1		(Accessories)		
18	Brass Coupler	P458C026	FOOT	47	Lubricator		1
19	Hose Clamp	P458C027	FOOT	48	Regulator		1
20	3/8" Rubber Hose 14"	P458C028	1.34'	49	Filter (Water Trap)		1
21	Cap	P458C029	1	50	Accessory Bracket		1
22	1/4" Rubber Hose 36"	P458C030	3'	51	Nipple		3
23	Handle Grip	P458C031	2	52	Brass Coupler		1
24	Drain Valve	P458C032	2	53	Gauge		1
25	Twin Tank Assembly	P458C033	1				



MAINTENANCE AND STORAGE

MAINTENANCE

During the lubrication stop, inspect all operating parts. Should any damage or excessive wear be evident, replace parts immediately. Straighten any parts as soon as possible. Clean and re-paint all exposed parts using touch-up kit P3020B034 **yellow** paint or touch-up kit P3020B033 **black** paint.

STORAGE

Perform all required maintenance and lubrication procedures. Coat all shafts with grease. Clean and re-paint all exposed parts using touch-up kit P3020B034 **yellow** paint or touch-up kit P3020B033 **black** paint.

Each touch-up kit includes:

1-pint paint can --- 1 pair of gloves --- 1 touch-up paintbrush